

LifeGear L2/DUMBBELL RACK

ITEM NO.: 76270

LifeGear

Get active for life

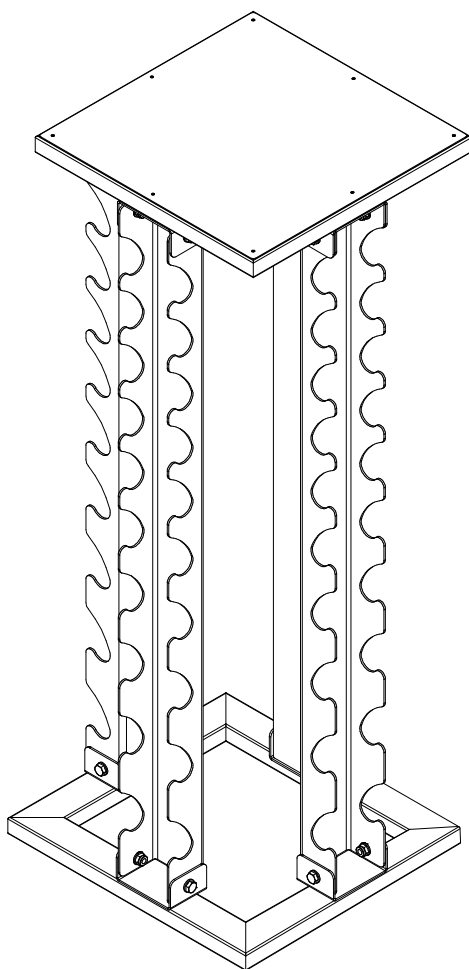

OWNER'S MANUAL

IMPORTANT: Read all instructions carefully before using this product. Retain this owner's manual for future reference.

The specifications of this product may vary from this photo and are subject to change without prior notice.

2024, Nov.

TABLE OF CONTENTS

WARRANTY -----	1
IMPORTANT SAFETY INSTRUCTIONS -----	2
MAINTENANCE -----	2
HARDWARE LIST -----	2
TOOL -----	2
EXPLODED VIEW & PARTS LIST -----	3
ASSEMBLY INSTRUCTIONS -----	4

ONE YEAR LIMITED WARRANTY

LifeGear Inc. warrants to the original purchaser that this product is free from defects in material and workmanship when used for the purpose intended, under the conditions that it has been installed and operated in accordance with LifeGear's Owner's Manual. LifeGear's obligation under this warranty is limited to replacing or repairing free of charge, any parts which may prove to be defective under normal home use. This warranty does not include any damage caused by improper operation, misuse or commercial application.

From the date of purchase, the frame is warranted to be free from defects for 1 (one) year. This warranty is offered only to the original owner and is not transferable. Proof of purchase is required.

When ordering replacement parts please have the following information ready:

1. **Owner's Manual**
2. **Model Number**
3. **Description of Parts**
4. **Part Number**
5. **Date of Purchase**

IMPORTANT SAFETY INSTRUCTIONS

Basic precautions, including the following important safety instructions, should always be followed when using this dumbbell rack. Read all instructions before use.

1. Ensure all parts are undamaged and securely fixed before use. Place the dumbbell rack on a flat surface.
2. Only perform maintenance or adjustments as described in this manual.
3. Do not place this dumbbell rack outdoors.
4. This dumbbell rack is for household use only.
5. Keep children and pets away from the dumbbell rack.

MAINTENANCE

Wipe dust from the dumbbell rack with a clean, dry cloth.

Inspect all bolts and nuts to ensure they are properly tightened, and check the frame for any signs of cracking or permanent bending. If such issues are found, discontinue use of the dumbbell rack.

HARDWARE LIST

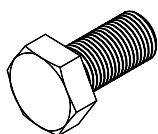

(4) Bolt M10x20
16 PCS



(5) Washer Ø10
32 PCS

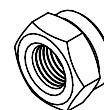

(6) Nylon Nut M10
16 PCS

TOOL

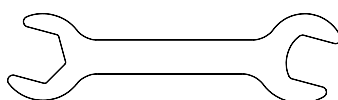

Wrench 14-17
2 PCS

EXPLODED VIEW & PARTS LIST

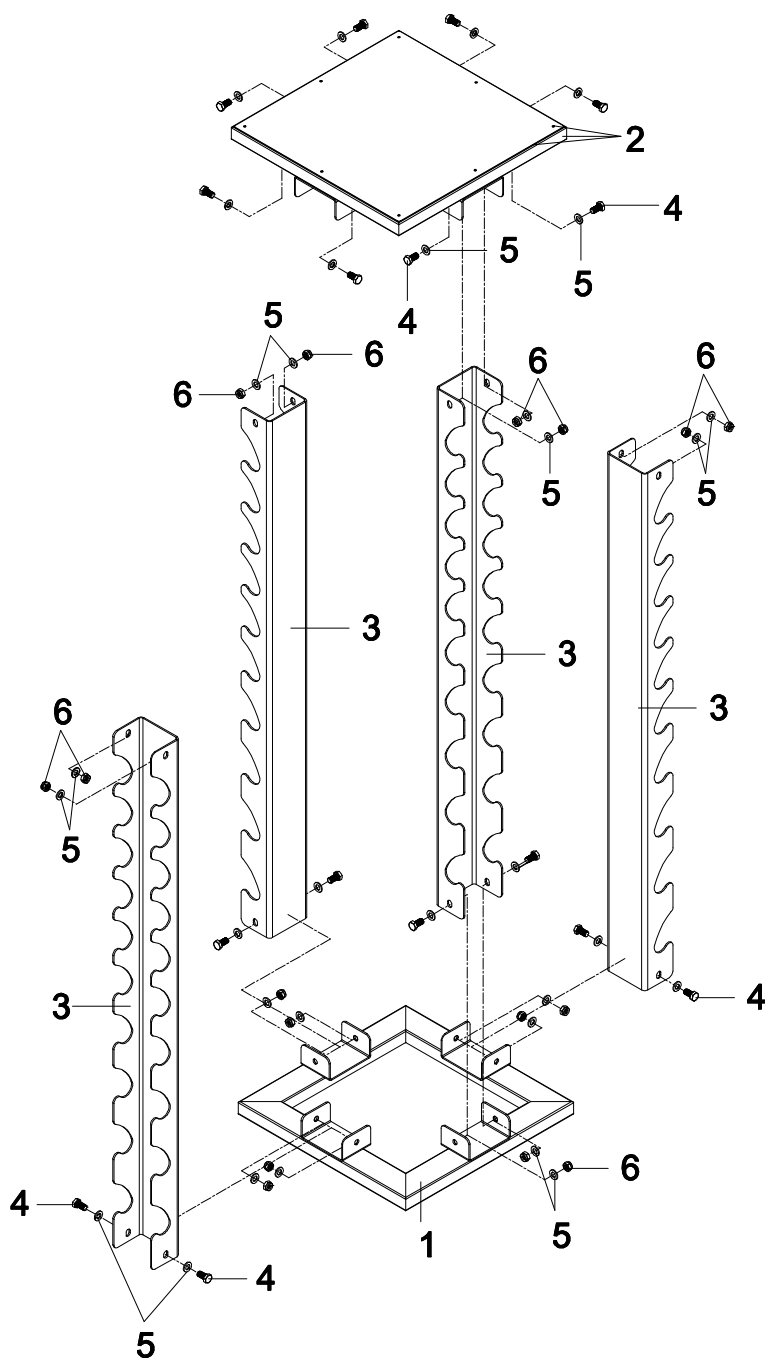

No.	Description	Qty
001	Base Frame	1
002	Top Frame	1 Set
	Rivet	
	Iron Plate	
003	Dumbbell Frame	4
004	Bolt M10x20	16
005	Washer Ø10	32
006	Nylon Nut M10	16

ASSEMBLY INSTRUCTIONS

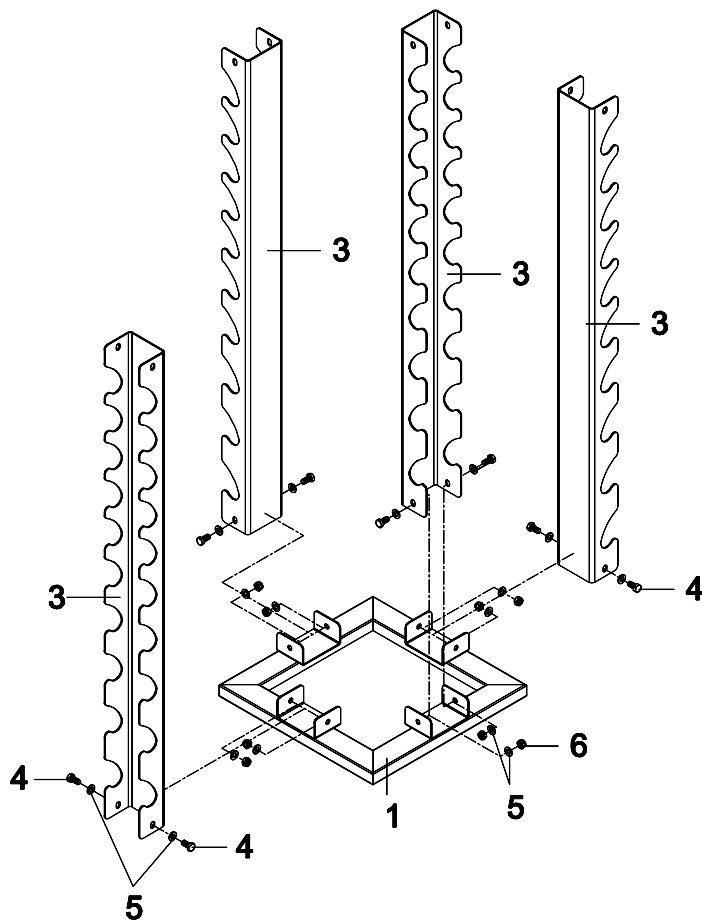

Tool:

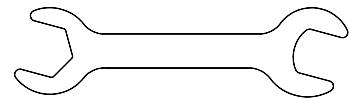

Wrench 14-17
2 PCS

Step 1

Attach four Dumbbell Frames (3) onto the Base Frame (1) with eight M10x20 Bolts (4), sixteen Ø10 Washers (5), and eight M10 Nylon Nuts (6). Tighten the bolts and nuts with two Wrenches provided.

Hardware:

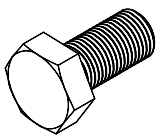

(4) Bolt M10x20
8 PCS



(5) Washer Ø10
16 PCS

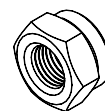

(6) Nylon Nut M10
8 PCS

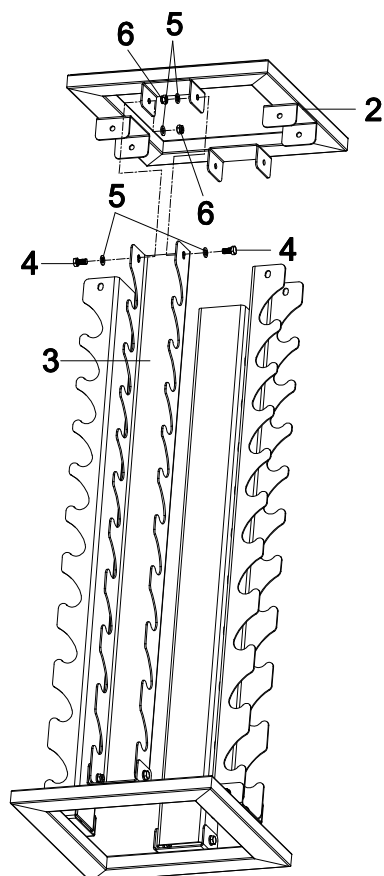

Tool:

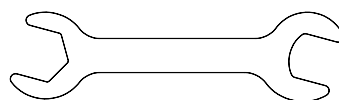

Wrench 14-17
2 PCS

Step 2

Attach the Top Frame (2) onto the Dumbbell Frames (3) with eight M10x20 Bolts (4), sixteen Ø10 Washers (5), and eight M10 Nylon Nuts (6). Tighten the bolts and nuts with two Wrenches provided.

Hardware:

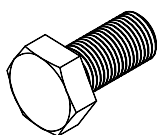

(4) Bolt M10x20
8 PCS

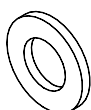

(5) Washer Ø10
16 PCS

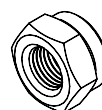

(6) Nylon Nut M10
8 PCS