

# ***LifeGear L2/DUMBBELL RACK***

## ***ITEM NO.: 76270***

***LifeGear***

Get active for life

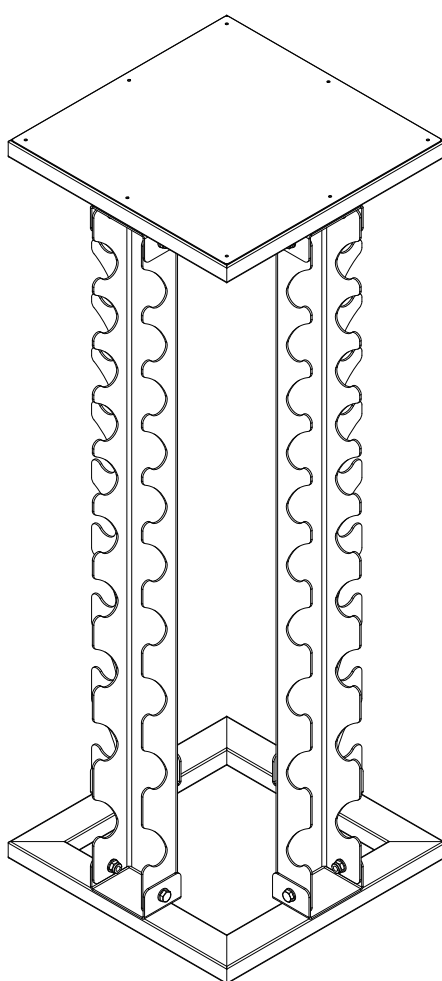

## ***OWNER'S MANUAL***

***IMPORTANT: Read all instructions carefully before using this product. Retain this owner's manual for future reference. The specifications of this product may vary from this photo, subject to change without notice.***

# TABLE OF CONTENTS

WARRANTY -----	1
SAFETY INSTRUCTIONS -----	2
MAINTENANCE -----	2
HARDWARE PACKING LIST-----	2
TOOL -----	2
OVERVIEW DRAWING & PARTS LIST -----	3
ASSEMBLY INSTRUCTIONS -----	4

## ONE YEAR LIMITED WARRANTY

LifeGear Inc. warrants to the original purchaser that this product is free from defects in material and workmanship when used for the purpose intended, under the conditions that it has been installed and operated in accordance with LifeGear's Owner's Manual. LifeGear's obligation under this warranty is limited to replacing or repairing, free of charge, any parts which may prove to be defective under normal home use. This warranty does not include any damage caused by improper operation, misuse or commercial application.

From the date of purchase, the frame is warranted to be free from defects for 1 (one) year.

This warranty is extended only to the original owner and is not transferable.

When ordering replacement parts please have the following information ready:

1. **Owner's Manual**
2. **Model Number**
3. **Description of Parts**
4. **Part Number**
5. **Date of Purchase**

# SAFETY INSTRUCTIONS

Basic precautions should always be followed, including the following safety instructions when using this dumbbell rack: Read all instructions before using this dumbbell rack.

1. Please make sure all parts are not damaged and fixed well before use. This dumbbell rack should be placed on a flat surface.
2. Do not attempt any maintenance or adjustments other than those described in this manual.
3. Do not place this dumbbell rack outdoors.
4. This dumbbell rack is for household use only.
5. Keep children and pets away from dumbbell rack.

## MAINTENANCE

Please wipe dust off the dumbbell rack with a clean, dry cloth.

Please inspect all assembly bolts and nuts on the dumbbell rack for proper tightness and frame of the dumbbell rack for any sign of cracking or permanent bending. If you find this situation, do not use this dumbbell rack.

## HARDWARE PACKING LIST

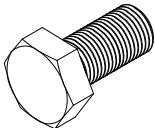

(4) Bolt M10x20  
16 PCS

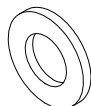

(5) Washer Ø10  
32 PCS

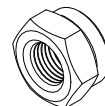

(6) Nylon Nut M10  
16 PCS

## TOOL

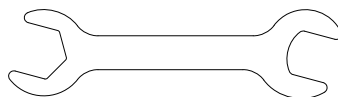

Wrench 14-17  
2 PCS

# OVERVIEW DRAWING & PARTS LIST

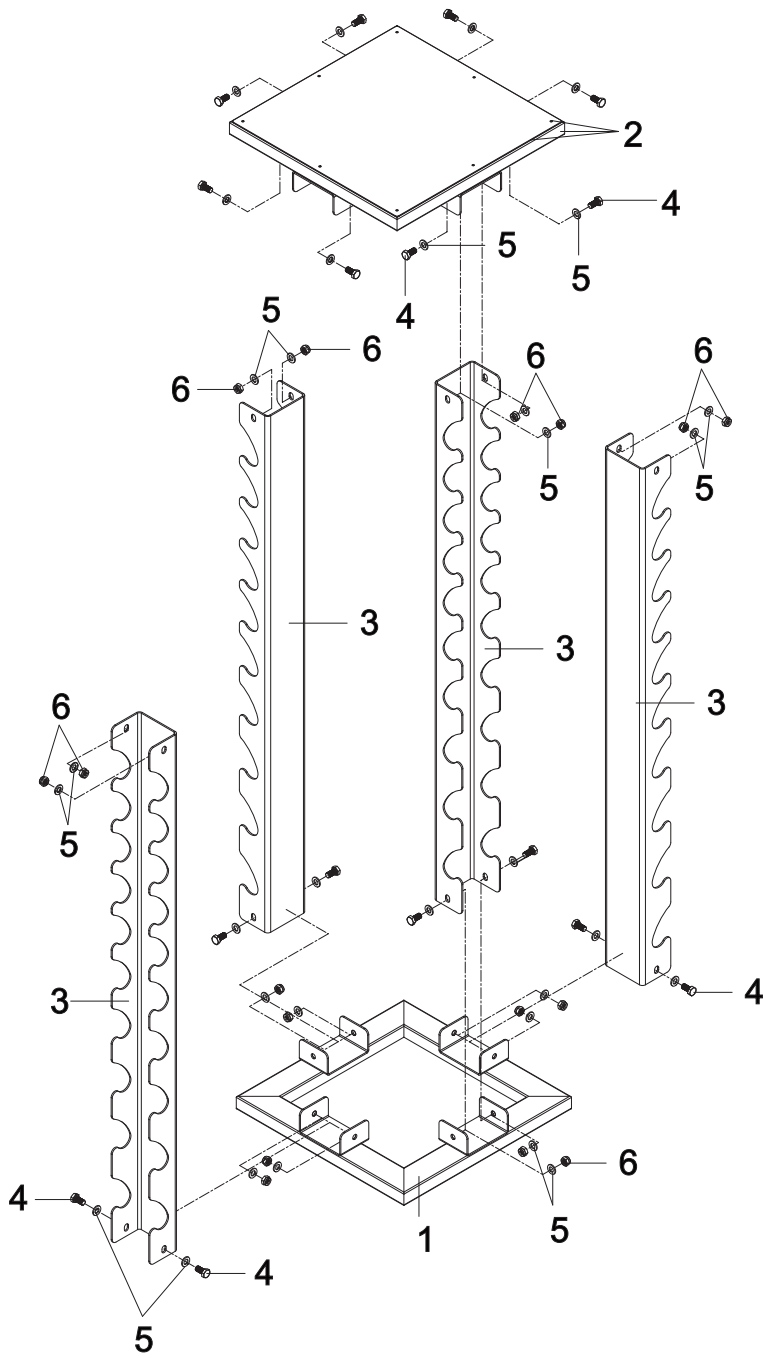

No.	Description	Qty
001	Base Frame	1
002	Top Frame	1 Set
	Rivet	
	Iron Plate	
003	Dumbbell Frame	4
004	Bolt M10x20	16
005	Washer Ø10	32
006	Nylon Nut M10	16

# ASSEMBLY INSTRUCTIONS

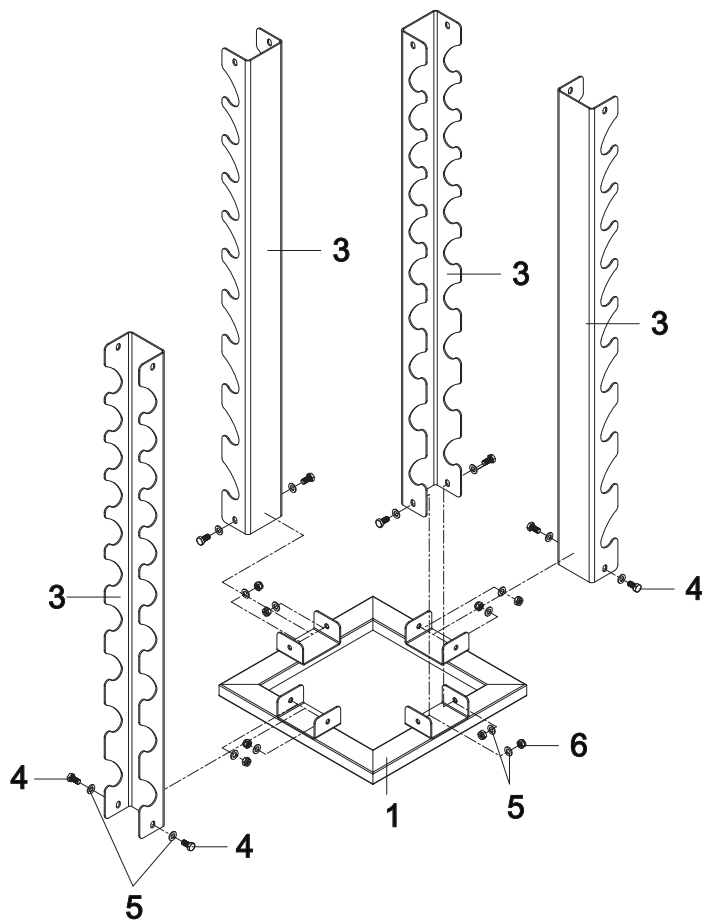

## Tool:

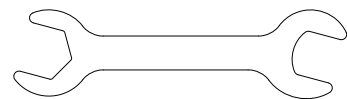

2 Wrenches 14-17

## Step 1

Attach four Dumbbell Frames (3) onto the Base Frame (1) with eight M10x20 Bolts (4), sixteen Ø10 Washers (5), and eight M10 Nylon Nuts (6). Tighten bolts and nuts with two Wrenches provided.

## Hardware:

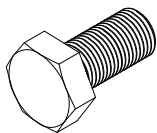

8 Bolts (M10x20)

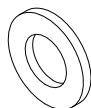

16 Washers (Ø10)

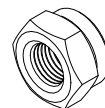

8 Nylon Nuts (M10)

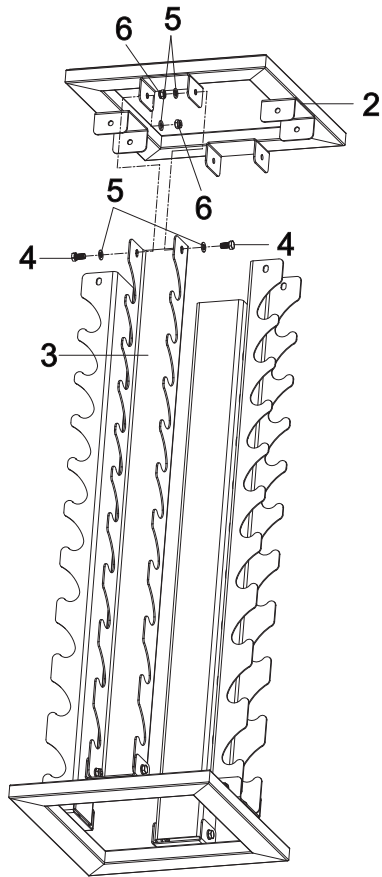

**Tool:**



*2 Wrenches 14-17*

**Step 2**

Attach the Top Frame (2) onto the Dumbbell Frames (3) with eight M10x20 Bolts (4), sixteen Ø10 Washers (5), and eight M10 Nylon Nuts (6). Tighten bolts and nuts with two Wrenches provided.

**Hardware:**

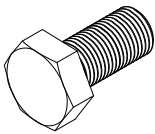

*8 Bolts (M10x20)*

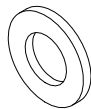

*16 Washers (Ø10)*

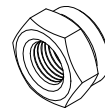

*8 Nylon Nuts (M10)*